

# Aerial Map - Tract 4



Boundary Center: 42.718538, -94.269270



# Growthland

**4-91N-29W**  
**Humboldt County**  
**Iowa**



Maps Provided By:



© AgriData, Inc. 2023 www.AgriDataInc.com

# Tillable Soils Map - Tract 4

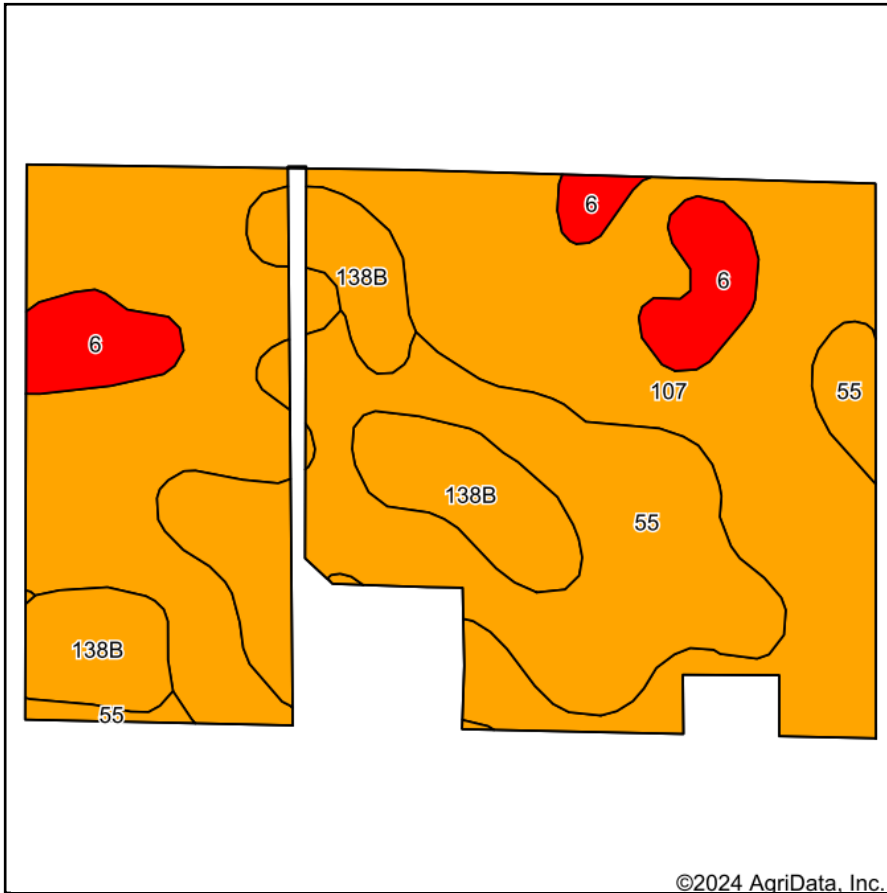

©2024 AgriData, Inc.

Soils data provided by USDA and NRCS.

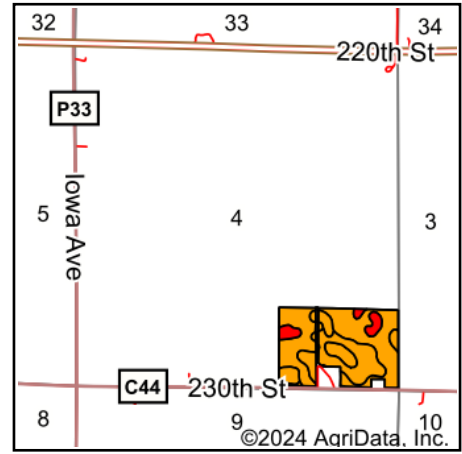

State: **Iowa**  
 County: **Humboldt**  
 Location: **4-91N-29W**  
 Township: **Corinth**  
 Acres: **52.13**

## Growthland

Maps Provided By:



Area Symbol: IA091, Soil Area Version: 29

Code	Soil Description	Acres	Percent of field	CSR2 Legend	CSR2**
107	Webster clay loam, 0 to 2 percent slopes	28.37	54.3%		86
55	Nicollet clay loam, 1 to 3 percent slopes	13.85	26.6%		89
138B	Clarion loam, 2 to 6 percent slopes	6.39	12.3%		89
6	Okoboji silty clay loam, 0 to 1 percent slopes	3.52	6.8%		59
<b>Weighted Average</b>					<b>85.3</b>

\*\*IA has updated the CSR values for each county to CSR2.

Soils data provided by USDA and NRCS.

**Acreage Breakdown:**

**Taxable Acres:** 54.83  
**Estimated Tillable Acres:** 52.13\*

**Soil Productivity:** **Tillable CSR2:** 85.3

**Property Taxes:** \$3,670.00

**Parcel Numbers:** 1004400005 1004400006

\*Pending FSA reconstitution after sale completion. The figures listed are estimates.

If tracts 4 & 5 are sold separately an access easement for the existing gravel drive will be provided to Tract 5.